

Section

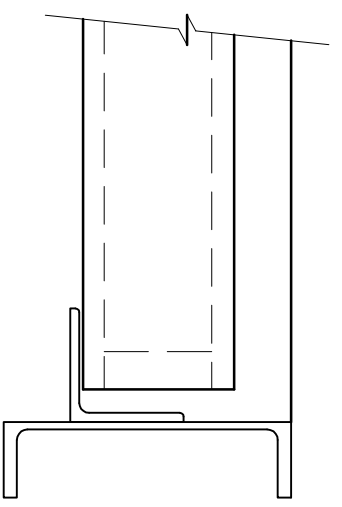

Section X-X

Comments / Notes:

HOLLOW CORE CONCRETE PTY. LTD.
 A.B.N. 22 006 885 468
 Structural Precast Components
 12-14 Marra Street
 Laverton North
 Victoria 3026
 Tel. (03) 9369 4944 Fax. (03) 9369 2025
 Email: info@hollowcore.com.au
 www.hollowcore.com.au

Project _____

Client _____

Title _____

Steel Trimmer Details

Drawn By _____ **Checked By** _____

Scale _____ **Date** _____

Job No. _____ **Drawing No.** **4.10** **Revision** _____